



TRADE PARTNER OUTREACH EVENT

Networking Event – 10/28/2025

Bid Package 11 – Public Safety
Building



COLUMBUS
REGIONAL AIRPORT AUTHORITY



WHY ARE WE HERE?

- Acknowledgements
- Project Overview & Milestones
- Prequalification and Overall Opportunities
- GMP9A Overview
- Discuss our expectations of our trade partners during the bidding phase.



PROJECT OVERVIEW

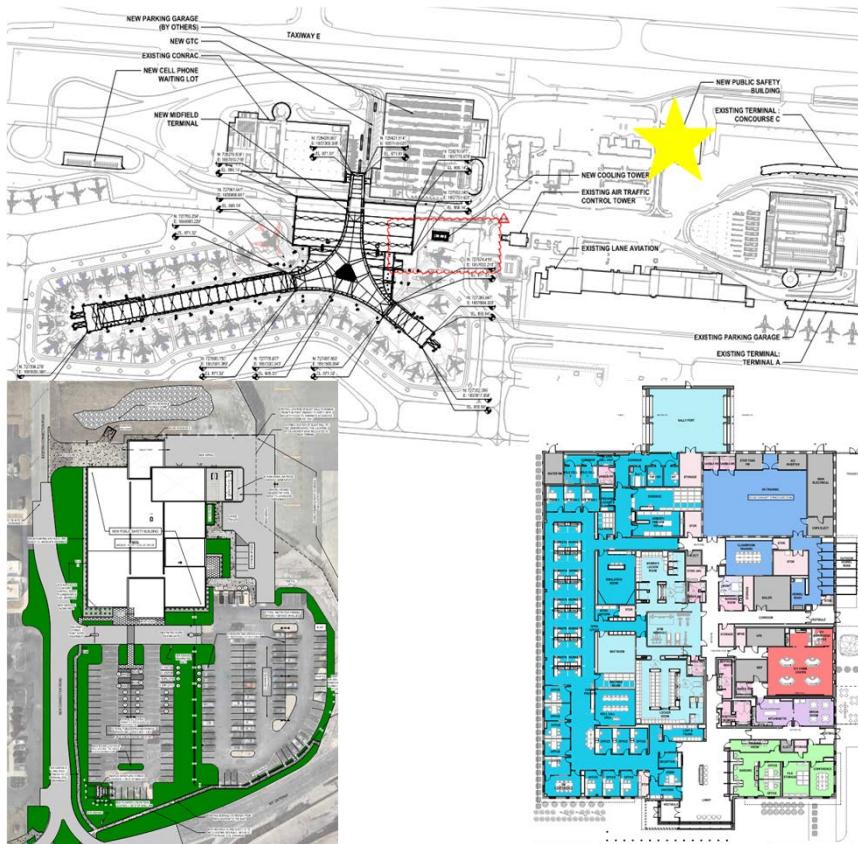

General: ~38,000 SF, Single Story, CMH's New Public Safety Building.

Intended Uses: Airport Police Station, Airport Badging Office, Fitness & Locker Rooms, Administrative & Conference Spaces.

Unique Features: ICC-500 Storm Shelter Space, LEED Silver, 911 Call Center, K-9 Kennels & Training Center, Detention & Interview Rooms, New Secure Boundary to CMH Ramp Operations.

Civil & Landscape: Demolition, New Utilities, Existing Asphalt Mill & Overlay, Hardscapes, New Secure Site Fencing, Plantings.

Structure & Shell: Cast-in-Place Foundations, Structural Masonry, Steel Structure, Metal Panel, Glazing, & Curtain Wall Façade, PVC Roof.

MEPFPT: Water Source Heat Pump & Dedicated Outside Air Systems, Emergency & Standby Power Systems, Sprinklers & Fire Alarm, Fireproofing, Siphonic Drainage, AV, Security, BMS, Access Control, Crash Phone, & Antenna Farm.

Interiors: Over 80 Rooms with Varying Finishes. Mix of Masonry and Drywall Partitions, ACT, Range of Flooring, Access Control Doors, Windows Shades, Variety of FF&E, & Signage.

PROJECT MILESTONES

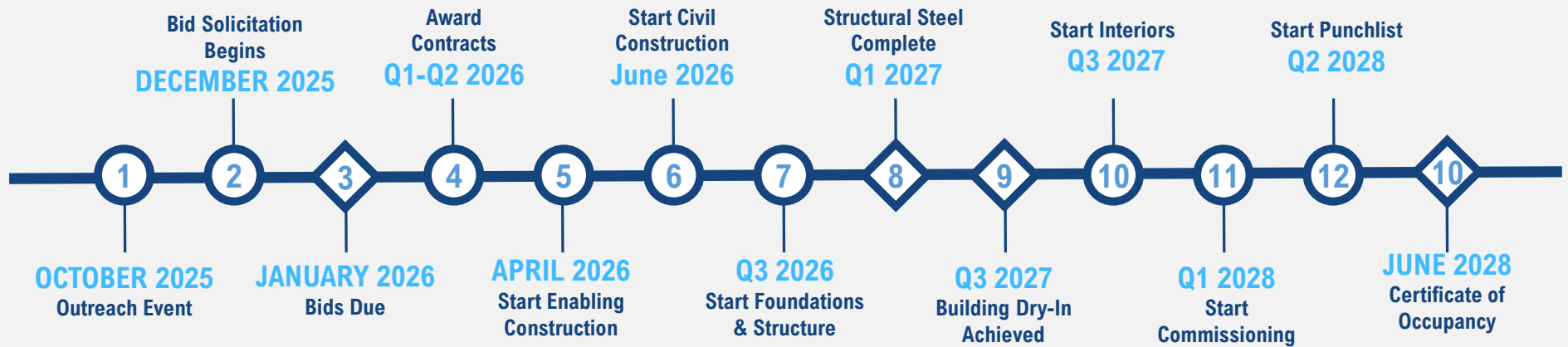

PROCESS OF BIDDING

Pre-Qualification Package

Notice of Pre-Qualification

Receive Solicitation from Building Connected:

- Include Bid Package of Scope
- After Submission, Review Internally
- Commence with Scope Interviews
- Award Recommendation

Award to Best Value as per CRAA contract

PROJECT OPPORTUNITIES: GMP9A SCOPES

CMH NEXT

- Site Civil
- Steel
- Concrete
- Electrical
- Plumbing
- HVAC
- Low Voltage
- Masonry
- Metal Panel
- Roofing
- Fire Protection
- Fire Proofing
- Exterior Canopies
- Fencing
- Paving
- Equipment
- Misc. Metals
- Millwork
- Rough Carpentry
- Doors, Frames & Hardware &
- Overhead Doors
- Interior Glass & Glazing
- Interior Drywall and Related
- Wall Coverings
- Resinous Flooring
- Resilient & Carpet
- Tile
- Painting
- Building Specialties
- Bathroom Accessories
- Window Shades
- Exterior Landscaping
- Cx Coordination



GMP 9A



Major Schedule Commitments:

- Issue Solicitation: December 1, 2025
- Cut-off Date for RFIs: December 19, 2025
- Proposal Due Date: January 13, 2026
- Interviews: Starting February 2026
- First Scope of Work Starts: Q2 2025 (Civil)



BID CHECKLIST DELIVERABLES

Documents to Accompany Bids

The following documents must be received from all bidders:

- ✓ Bid Form (Lump Sum)
 - ✓ Target Cost of Work
 - ✓ Technical Proposal
 - ✓ Subcontractor Insurance Limits and Coverage
 - ✓ JIP Brochure Acknowledgement
-
- ✓ Any other items specifically requested on the bid form.



CONTRACT AWARD PROCESS

- Best Value Award
 - Completion of Proposal
 - Competitively Priced
 - Scope Performance History
 - Past Performance
 - Safety



**QUESTIONS... Submit
as Formal RFI via email**



HENSEL PHELPS
Plan. Build. Manage.



CONTACT INFORMATION

Denise Gilliam

Small Business Liaison

- ✓ M – 614.285.2796
- ✓ Email – dgilliam@elford.com

Daniel Fils-Aime

Small Business Liaison

- ✓ M – 484.241.0386
- ✓ Email – dfils-aime@henselphelps.com

Jay Withington

Senior Estimator

- ✓ Email – jwithington@henselphelps.com

Spencer Hazen

Project Manager

- ✓ Email – shazen4@henselphelps.com

Ryan Carroll

Project Superintendent

- ✓ Email – rcarroll@henselphelps.com





CHUCK MAY
Project Executive



KEVIN PARKER
General Superintendent



CALLIE HEPLER
Operations Manager



SPENCER HAZEN
Project Manager



RYAN CARROLL
Project Superintendent



JAY WITHINGTON
Senior Estimator



DANIEL FILS-AIME
Small Business Liaison



JAMES HARPER
Small Business Liaison



DENISE GILLIAM
Small Business Liaison



TEAM MEMBERS



HENSEL PHELPS
Plan. Build. Manage.

